



Serving People through  
Parks and Programs

## Prairie Duneland Trail

Completed in July of 1996, the Prairie Duneland Trail is part of the Northwest Indiana Regional Bikeways Plan. In the near future, the trail will be extended in both directions by adjoining communities creating the Lake Michigan Heritage Greenway. This trail forms the backbone of the Northwest Indiana Regional Bikeways Plan and will stretch 40 miles from Hammond to Michigan City, Indiana.

### Trail Distances:

- .47 miles - Countyline Rd. to Route 6
- .97 miles - Route 6 to Swanson Rd.
- .86 miles - Swanson Rd. to Willowcreek Rd.
- 1.15 miles - Willowcreek Rd. to Airport Rd.
- .60 miles - Airport Rd. to Samuelson Rd.
- .58 miles - Samuelson Rd. to McCool Rd.
- .85 miles - McCool Rd. to Lenburg Rd.
- .30 miles - Lenburg Rd. to State Road 149
- 5.78 miles

## Prairie Duneland Trail

**Site Data:** Distance: 5.78 miles  
Surface: asphalt, 12' width  
Activities: non-motorized activities

**Amenities:** Interpretive and orientation signs, mile markers, picnic facilities, drinking fountains, benches, bike racks, and restrooms.

### Key:

- P Parking
- R Restroom
- == Prairie Duneland Trail
- T Tunnel

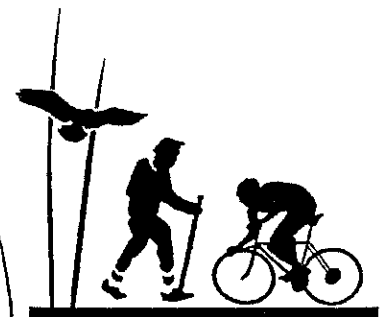
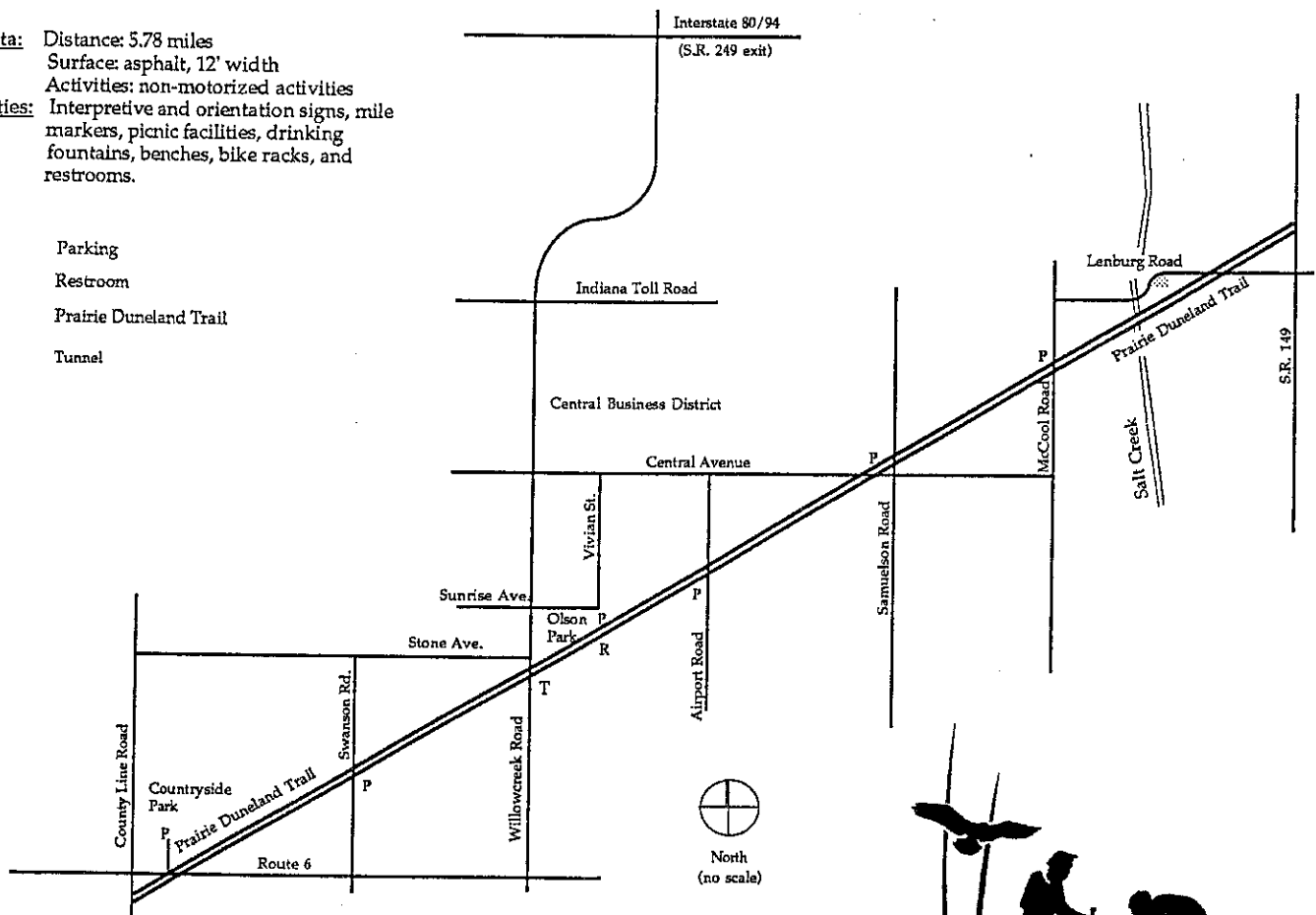

PRAIRIE  
DUNELAND  
TRAIL

### Trail Manners...

- \*Respect the rights of the trail neighbors. Please stay on the trail.
- \*Trail is closed from dusk to dawn.
- \*Take only pictures, leave only footprints.
- \*Pets must be kept on a leash. Animal waste must be removed from the trail.
- \*Motorized vehicles are not permitted.
- \*Alcohol is prohibited along the trail.
- \*The trail has multiple uses, so be considerate of one another.